

PROCHANNELd-line

Tools: Folding ruler, spirit level, bracket 90 degree agitator, angle grinder (if possible with speed control), stainless steel cutting disc, smooth file cut 3 (caution: only file stainless steel with it), grout bucket or trough, trowel, smoothing trowel, sponge, cutter knife, scissors, radiator brush (40 - 50 mm width)

Additional material for sealing: PROFOLIO sealing and decoupling membrane, PROFOLIO sealing tape, PROFOLIO sealing tape corners, PROFIX DS, PROFOLIO compensation corner

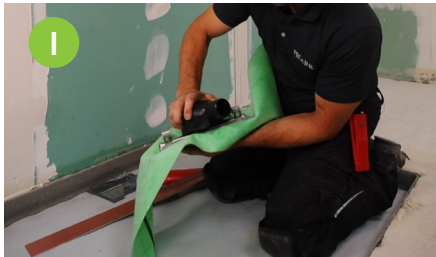

1 Selection of drain pan (depends on discharge water from shower fitting and existing installation heights) and installation of the drain pan on the drain nozzle of the PROCHANNELd line drainage line housing.



2 Connect the pipe socket of the drain pan DN 50 to the sleeve of the drainage pipe. Use of lubricant is recommended. Install installation feet as required and move the channel to the desired height. Observe gradient of 1.5 - 2 % to the drainage line housing!



3 Align the drainage line housing with the wall and the adjoining surfaces and take the mean



4 Determine the length of the shower profile. Mark the shower profile on the adjacent floor areas.



5 Water sample: Pour the water into the drainage line housing and check the spigot joint for tightness.



6 Check the clearance again as well as straightness of the drainage line housing.

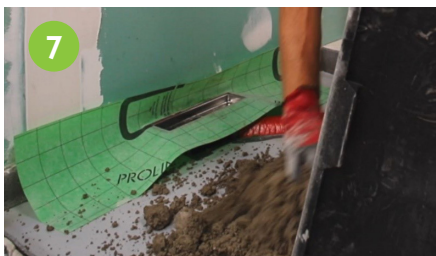

7 Insert the sloping screed (earth-moist consistency) in the intended installation site of the PROCHANNELd line.



8 Undergird the drainage line housing with the sloping screed. Make sure that the drainage line housing is well embedded in the screed floor. Cavities below the drainage line housing must be avoided by all means!



9 Level the sloping screed with the spirit level. Consider the gradient (1.5 - 2 %) to the drainage line housing.

PROCHANNELd-line



10 Plane the screed surface with the smoothing trowel.



11 Insert the dirt guard in the drainage line housing and fix with adhesive tape (e.g. masking tape).



12 Fit the PROFOLIO sealing and decoupling membrane to the floor areas (please refer to the product data sheet 523 PROFOLIO with PROFIX DS).



13 Seal the wall areas with the PROFOLIO sealing and decoupling membrane.

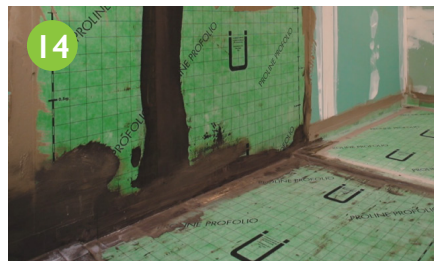

14 The complete bath situation must be sealed in accordance with DIN 18534-1.



15 Remove the dirt guard from the drainage line housing.



16 Use a bracket to transfer the division lines to the shower profile.

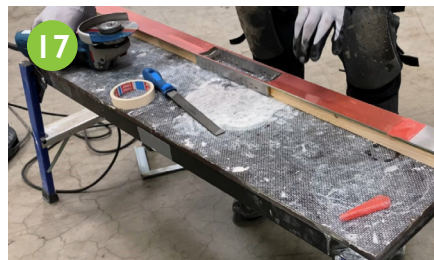

17 The shower profile should be well supported when separating it, i.e. by means of two roof battens for underpinning the profile. The roof battens only extend to the frame of the shower profile. The protective film is only removed in the cutting area and remains on the profile until final completion of the bath.



18 Separate the shower profile at the respective markings with the angle grinder and the stainless steel cutting disc (item no. 94230/94240). Caution: Only stainless steel must have been cut with the discs!



19 Debur the cut edges using the smooth file. Only stainless steel must have been cut with the file beforehand. If other common more ignoble mild steel has been machined with the file, there is a risk of external rust on the cut edges.



20 Insert the height distance clips in the cascade adjustment of the shower profile frame. The clips are inserted in the respective recesses based on the calculated tile height plus addition of the adhesive bed thickness. Heights between 10 and 17 mm can be realised.



21 Apply tile adhesive to the bottom of the shower profile in a wedge shape.

PROCHANNELd-line



Insert the shower profile in the drainage line housing and position at the desired height using an adhesive bed. Remove excess adhesive in a timely and neat manner.

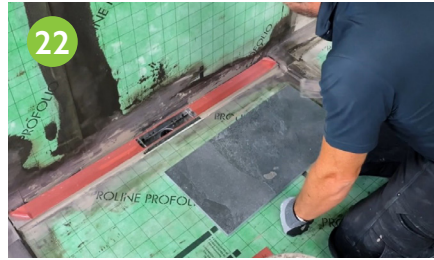

Leave the adhered shower profile to harden according to adhesive manufacturer specifications. Once the adhesive has hardened, tiling can start.



With its special "Push function", the profile cover can easily be removed by hand without auxiliary means.

Maintenance and care:

With its technical design and the selected materials, the shower profile can be cleaned quickly and easily. The inner gradient optimises the water drainage and self-cleaning effect. The shower profile, the drainage line housing and the profile cover are made of stainless steel, thus also providing excellent hygienic properties.

It is normally sufficient to rinse the shower profile with water and wipe and dry it with a soft cloth (e.g. cotton). Make sure the cloth does not scratch. For example, only microfibre cloths should be used that are suitable for surface stainless steel. Only mild household cleaning agents should be used as cleaners. Do not use cleaners with strong acids, chlorine or bleaches. Always only apply cleaning agent briefly, wipe off and thoroughly rinse with water. In order to clean the drain, the profile cover can be easily removed by hand with its special "Push function".

All details, references, notes, applicable specialist regulations, guidelines, standards and specialist knowledge are directed towards the German, and insofar as they are congruent, to the existing European regulations and training standards, irrespective of additional country-specific extensions or modifications.

All our information is based on our experience and carefully performed tests. The variety of additional materials that might be used and differing construction and working conditions cannot be individually checked or influenced by us. The fulfilment of an outstanding service contract and the manufacturing of a demonstrable functional capability of the trades is therefore dependent on adhesion to the current VOB (German Construction Contract Procedures) regulations and recognised technological rules.

Our details do not preclude responsible planners and processors from their duty to independently assess the conditions of a building and suitable application of the products. In case of doubt, please seek technical application advice or carry out your own tests. The manufacturer's guidelines for laying and processing the surfacing material or the guidelines for other products used must be observed.

The publication of this product data sheet invalidates all previous product data sheets.

© Proline Systems 2021 – reproduction and passing on by our customers to their customers is permitted, insofar as there is a clear indication of our copyright. All other rights reserved.