

PROROUND PVC

Round-edged profiles for floors and walls

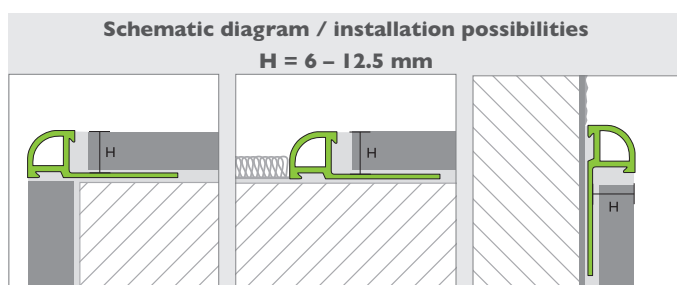

Fields of application:

The PROROUND round-edged profile in PVC is a decorative quadrant profile, available in many colours, for the visible accentuation of covering edges and corners in rooms. At the same time, it protects covering edges against mechanical influence and damage from light knocks/impact.

Even transitions are achieved when supplemented with internal and external corner pieces.

The design of PROROUND PVC round-edged profiles is matched to the coverings in such a way that, with a high level of application safety during installation, the loads experienced in domestic inside areas can be borne reliably and with lasting effect.

Typical areas of application are, e.g.:

- Transitions and covering edges of a wide variety of materials (e.g. tiles, natural and artificial stone, wooden panelling, carpets and coatings on walls or other types of coverings and walls).
- Clean and decorative coverage on top of cut edges with skirting.
- Perfectly crafted finish and edge formation, e.g. for wall facing, ledges and reveals.

Product advantages:

PROROUND round-edged profiles are easy to fit. They protect edges and cover them with a coloured finish.

Due to different geometries, a wide variety of covering heights can be catered for.

The profiles can be shortened to length on-site.



PROROUND round-edged profiles are designed to take mechanical loads (e.g. knocks, impacts and similar) along the edges of wall coverings and to protect adjacent coverings.

The profile has a general level of resistance to the types of domestic loads encountered during later use of the surfaces and also in terms of laying wall coverings.

Specifications:

Material	PVC
Length [m]	2.50 / 3.00
Height [mm]	6 – 12.5
Temperature range in use	+5°C to +45°C

For details, see latest price list.

Delivery form:

Sanitary colours:	10 profiles = 1 package wrapped in film tubing, packaged in a dispatch box.
Intensive and pastel colours:	10 profiles = 1 package, bound at the ends with rubber band and packaged in a dispatch box.

Packaging unit:	10 / 50 / 300 items
Customs tariff number for PVC:	39259080

For the latest order quantities (KA) and packaging units (VPE), please refer to the price list, the relevant price sheets or product news sheets, or speak to your specialist dealer.

PROROUND PVC

Supplementary products:

PROLINE miter shears



PROROUND PVC
external and internal corner pieces
made from coloured PVC

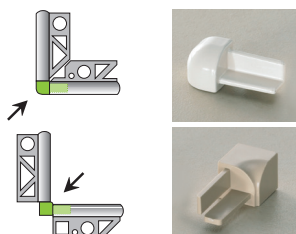

For details and colours,
see latest price list

Storage and transportation:

Store and transport in dry areas that are protected against sunlight, UV rays, dirt, impact, abrasion and other foreign matter. To avoid any risk of deformation, do not place any load on the profiles and preferably store in the lying position.

Disposal:

Profiles that have been cleaned of foreign matter can be disposed of in a plastic recycling container. Observe local authority regulations respectively.

Thermal degradation:

No degradation if used in the correct manner.
Do not subject to excessive temperatures. Do not burn profiles.

Processing:

Preparatory measures:

The surface to which the product is being fitted must be sturdy, dry, level, straight, flush and horizontal, free of parting agents and solvents and suitable for the bonding substance.

Installation:

Choose PROROUND round-edged profiles according to the planned thickness. For installation, the upper edge of the profile must always be at the same height or lower than the adjacent covering edges. Check the profile for damage – use only undamaged profiles.

To cut to the required length, use suitable clamps, saws or cutting devices as well as personal protective equipment.

Place the PROROUND round-edged profile with the stamped fitting strip equally in the fresh bonding compound and align. Then cover over completely. The flooring/covering material adjacent to the fitting strip must be laid so it is completely embedded.

If the surface as a whole has a joint pattern, the joint to the profile can be formed to match the joint width, though it should be no wider than 2 mm. The joint between the flooring/covering and the profile should be filled completely with grout.

Clean away any mortar/grout and adhesive residue immediately and completely using clean water and a non-abrading sponge pad or cloth from the sides of the profile on display. Bonding and joint filling substances should not dry onto the surface. Do not use abrasive bonding and joint filling substances.

Cleaning:

Use clean water and a cotton cloth as well as household cleaners without solvents or alcohol. Ensure that there is no sanding or grinding effect. Perform routine cleaning regularly in accordance with local conditions.

Chemical and physical resilience:

Check cleaning agents or collected water before use to determine whether they have a damaging effect on the profiles. This also applies to correct dosage during use. Do not use methylene chloride (DCM) or solvent-based substances on the profile.

PVC profiles have a tendency to discolour if exposed to strong sunlight.

PVC is not sensitive to diluted acids and alkaline solutions, such as water with chlorine.

The material is resistant to fungal growth and bacteria.

Always remove grout and joint compound immediately from the sides on display or mask off the visible sides to protect them. Once the adhesive, grout and filling compound has hardened completely, the profile can take mechanical loads as per its intended use.

Abrasive influences or the use of damaging equipment or activities on the profile should be avoided.

PROROUND PVC

Check cleaning tools and equipment with bristles and abrasive polishing pads to see if they scratch the surface.

Standards and regulations:

In addition to the observation and consideration of relevant specialist rules, standards and generally recognised rules of technology, attention is drawn in particular to the following regulations:

- ATV DIN 18352 Tile laying work
- ATV DIN 18332 Natural stone work
- ATV DIN 18157 Fitting ceramic trim using thin-bed method
- ATV DIN 18202 'Tolerances in surface construction'
- ZDB bulletin 'Expansion joints' (last version)
- ZDB bulletin 'Flooring/covering subjected to high loads' (last version)

Important information:

- If joining with heavily pigmented grout, clean immediately to avoid colour staining.
- Due to different manufacturing processes, colour differences between the profiles and corner pieces cannot be ruled out.
- If joining with reaction resins, check first whether the surface of the profile could be damaged and that adhesive and grout can be removed completely.

All information, references, instructions, basic engineering principles, regulations, standards and expertise are based on German and largely equivalent European regulations and training standards, irrespective of additional country-specific supplements and amendments.

All our specifications are based on our experience and careful analysis. We are unable to examine or influence the diversity of associated materials used and the various construction site and processing conditions in detail. The quality and function of your work is therefore dependent on your professional construction site evaluation and utilisation of the products. In case of doubt, carry out your own tests or seek technical application advice. Please refer to the laying and processing guidelines of the floor covering manufacturers or the manufacturers of associated products. All previously published product data sheets cease to apply on publication of this product data sheet.

© Proline Systems 2016 – We grant our customers the permission of reproduction and transfer to their customers, provided that clear reference is made to our copyrights. All other rights reserved.